

Quick Start Guide



V810VD by ATEL

4G LTE Cat-4 Fixed Wireless Access Router + POTS Replacement

Models Covered:

Model	LTE Bands
V810VD	B2/4/5/12/13/14/66/71



About your V810: Device Display

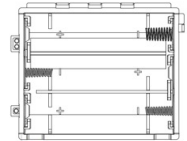
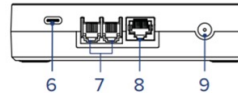
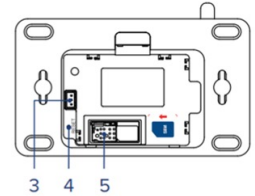
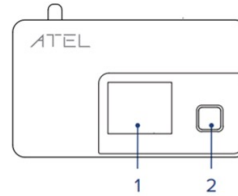

3 (Magnified)

<p>1. LCD Display Displays Home, Device Information, WiFi Login Information (SSID and Password), and Online Portal Login Information.</p>	<p>3. Battery Port This battery port is used to connect to the battery holder (3x AA batteries) or a Ni-MH rechargeable battery pack (may sold separately).</p>
<p>2. Power Button Power the V810 on/off by pressing and holding this button. You can also short press this button to wake up the screen and toggle screens to check device information</p>	<p>4. Reset Button Use a pin to push and hold this button for 3 seconds for factory reset.</p>

<p>5. SIM Card Slot Insert your 4FF SIM card into this spring-loaded SIM slot. To remove a SIM, press the edge of the SIM inward and the SIM would pop outward from the SIM slot.</p>	<p>8. Ethernet Port (RJ45) Insert an ethernet cable to this Port and plug the other end into your computer for internet access.</p>
<p>6. Type-C Port Use this port to connect the USB-C cable to a wall adapter for external power.</p>	<p>9. Antenna Connector Install an optional antenna (sold separately) to increase signal strength.</p>
<p>7. Phone Port (RJ11) Insert a telephone cord to this port and plug the other end into your telephone base.</p>	

Setting up your V810

Install SIM Card

1. Remove the V810 back cover.
2. Carefully lift the battery holder from the side.
3. Install the 4FF Nano SIM card into the spring-loaded SIM slot as the image shows. To remove a SIM, press the edge of the SIM inward and the SIM will pop outward from the SIM slot.

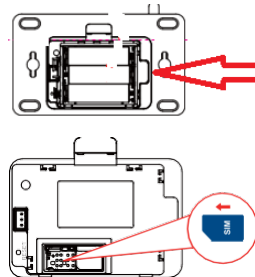

Install Battery

Remove the battery cover. Properly align and install 3 AA batteries into the battery holder. Put the battery cover back in place as shown in the image. Alternatively, a Ni-MH rechargeable battery pack (sold separately) can be connected to the Battery Port.

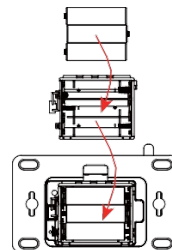
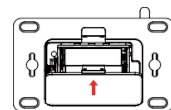
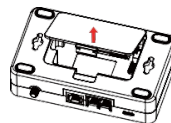
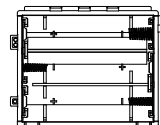

Note: During a power outage or if the wall charger is unplugged, the V810 continues to run off of the batteries to support Voice and Ethernet functions. Hotspot Wi-Fi function will not be available in AA battery-only mode, however.

During a power outage, only corded phones that do not require electric power can be used to make or receive calls (including calls to 911).

Equipment External Power

To connect your V810 to the power outlet, insert your USB cable to the device USB-C port and plug the other end into a wall adapter.

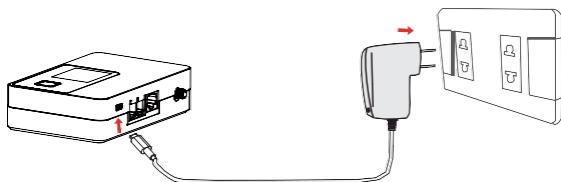

WARNING! Please only use the provided USB adapter for the V810. The use of other incompatible adapters may cause damage to your device and void the warranty.

Turning your V810 On/Off

To turn on your V810 press and hold the Power button. To turn off your V810, press and hold the Power button until you see the screen turn off.

Optional Add-On's: Install an Antenna

To increase signal strength, you can install an optional antenna.

1. Align the antenna with the antenna port and screw securely into place (in a clockwise direction).
2. Restart the V810 after the antenna is installed.

Note: Antenna sold separately. Using optional accessories (antenna and battery pack) by ATEL are recommended, available at ATEL website, <https://www.atel-usa.com/>.

LCD Display Icons Overview:

	Icon	Definition
Network Signal		Indicates the signal strength of your wireless provider in your location. More bars represent a stronger signal.
WiFi		(Voice + Data Models) WiFi available for connection.
Battery		Battery Level (Applies to NIMH Battery Only)
		Batteries Not Installed
		Battery Charging (Applies to NIMH Battery Only)
TTY	TTY	In TTY Mode
Power Key		Press the Power Key to switch menu screens.

Connect your Telephone to the V810

The V810 provides 2 telephone ports (RJ11). The ports use the same telephone number.

Plug the telephone cord into one of the telephone ports on the back of the V810 (the other end of the cord must remain plugged into the back of your home telephone base unit).

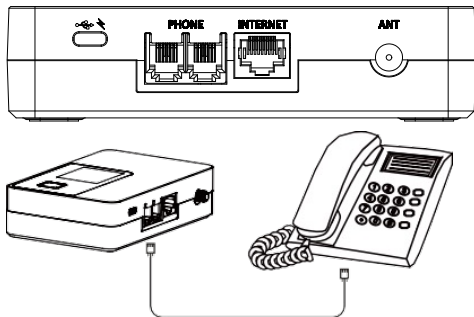

Note: The telephone and telephone cord are not included.

Make Calls

Before making a call, make sure at least one of the signal strength indicator bars () is lit up. If no signal bars are lit, move the V810 to a location that can receive a signal. Pick up the handle of your telephone then dial the number to use call services.

Using a Text Telephone

To use the V810 with TTY, you must first change the TTY mode from the default (None) to one of the following modes. From the connected telephone dial pad, dial “##56*n#” where “n” indicates the TTY mode:

- 0 – None (TTY) is disabled
- 1 – Full TTY Mode
- 2 – VCO mode
- 3 – HCO mode

Connect your Computer to the V810 Using the Ethernet Port

The V810 provides 1 Ethernet port (RJ45). For internet access, plug an ethernet cable to the Ethernet port of your V810 and connect it to the Ethernet port of your computer.

Note: the computer and ethernet cable are not included.

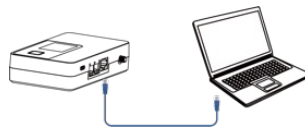

Connecting to Your V810 Hotspot Wi-Fi

Your V810 Hotspot supports up to 15 Wi-Fi connected devices. To connect to the Hotspot Wi-Fi;

1. Locate your Network Name (SSID) / Password from your V810 LCD Display or device label under the battery holder.

2. Open the Wi-Fi Settings of your Wi-Fi capable devices.
3. Select the SSID of your V810 from the available network list.
4. When prompted, enter the password of your V810.
5. You are connected to the Internet.

LCD Display

SSID: V810_3640
Password: 3833296c

Portal URL:
http://192.168.0.1/
Username: admin
Password: d62c39

Device Label

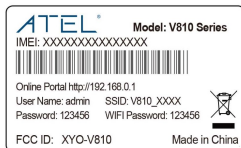

WebGUI Device Management Portal

You can access your V810 WebGUI Portal to view device status, change your device settings, and perform manual software upgrades.

1. First connect your computer to the V810 Hotspot Wi-Fi and then enter http://192.168.0.1 in the browser URL address bar. Note that you can also connect your V810 to a computer with a USB-C or ethernet (RJ45) cable to access the WebGUI portal.
2. The login username is "admin". The unique password can be found in the LCD Display menu or on the device label (under the battery holder).

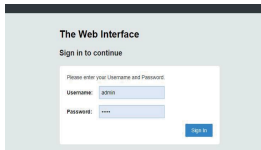

Changing Your WebGUI Portal Login Password

You can change the WebGUI Portal login password by going to Settings > Device Settings > Admin Password. Once changed, you must use the new password to login to the portal.

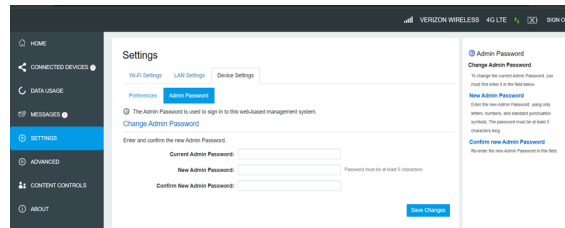

Managing Wi-Fi Networks and Connections

In the Wi-Fi Settings tab, you can change the Wi-Fi name (SSID) and password. You can also set the device to be working on the 2.4GHz or 5GHz of the 802.11 mode.

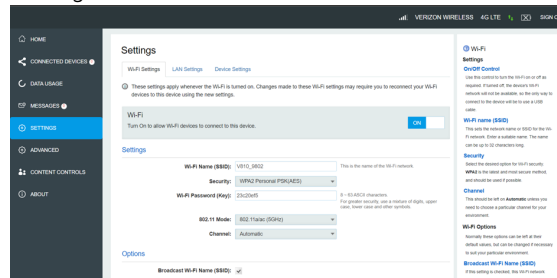

ATRACS Remote Management

You can manage the device using the ATEL Remote Management Platform ATRACS, by visiting <http://aags.a-tracs.com> or <https://aags.a-tracs.com>. Please refer to ATRACS User Manual for details.

Factory Resetting of Your V810

You can reset your V810 to factory default settings from the Online Portal or via the reset button.

Note: Resetting your V810 will disconnect devices and reset network names and passwords.

1. To reset the device from the Online Portal, click About > Backup and Restore > Restore to Factory Defaults. Click on “Restore Factory Defaults” to restore.



2. To reset the device from the reset button, make sure your V810 is powered on. Remove the battery cover from the back of your V810. Insert a pin into the Reset pin hole, push down and hold for 3 seconds. The device will restore the factory defaults and reboot.

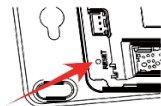

Regulatory Statements
Please review the Regulatory Statements for this device in the device User Manual, available at www.ATEL-USA.com.

Voice/Emergency calls:

ATEL cannot guarantee the voice or E911 calls availability. Making a successful call depends on your hardware (telephone) availability, physical location, wireless signal strength, and/or network services. You should never rely solely on any wireless mobile device for essential communications (medical emergencies, for example). Check with your wireless service providers. When making an emergency call, remember to give all the necessary information as accurately as possible.

Disclaimer:

Certain variations may be present between the device and user manual description depending on software release or specific network services. ATEL shall not be held legally responsible for such deviations, if any, nor for their potential consequences.

Limited Warranty:

The full ATEL USA Warranty Policy can be found at www.atel-usa.com/warranty. On this page you can “Start a Warranty Claim”, “Check on an Existing Claim” and read our Warranty Policy by clicking on “ATEL’s Warranty Policy”. Please follow all warranty instructions available and if you have any questions contact us at support@atel-usa.com.



@AsiatelcoUSA



@atel-asiatelco



@ATEL USA



@ATEL_USA

Our Website: www.atel-usa.com Contact us at: support@atel-usa.com
For Warranty information, see our website under the Support tab.

© 2023 Asiatelco Technologies, Inc. All Rights Reserved